

FOR SALE OR LEASE - ALDI EXCESS PROPERTY

±39,824 SF DIVISIBLE

16000 SOUTH HARLEM AVENUE, TINLEY PARK, ILLINOIS

RETAIL

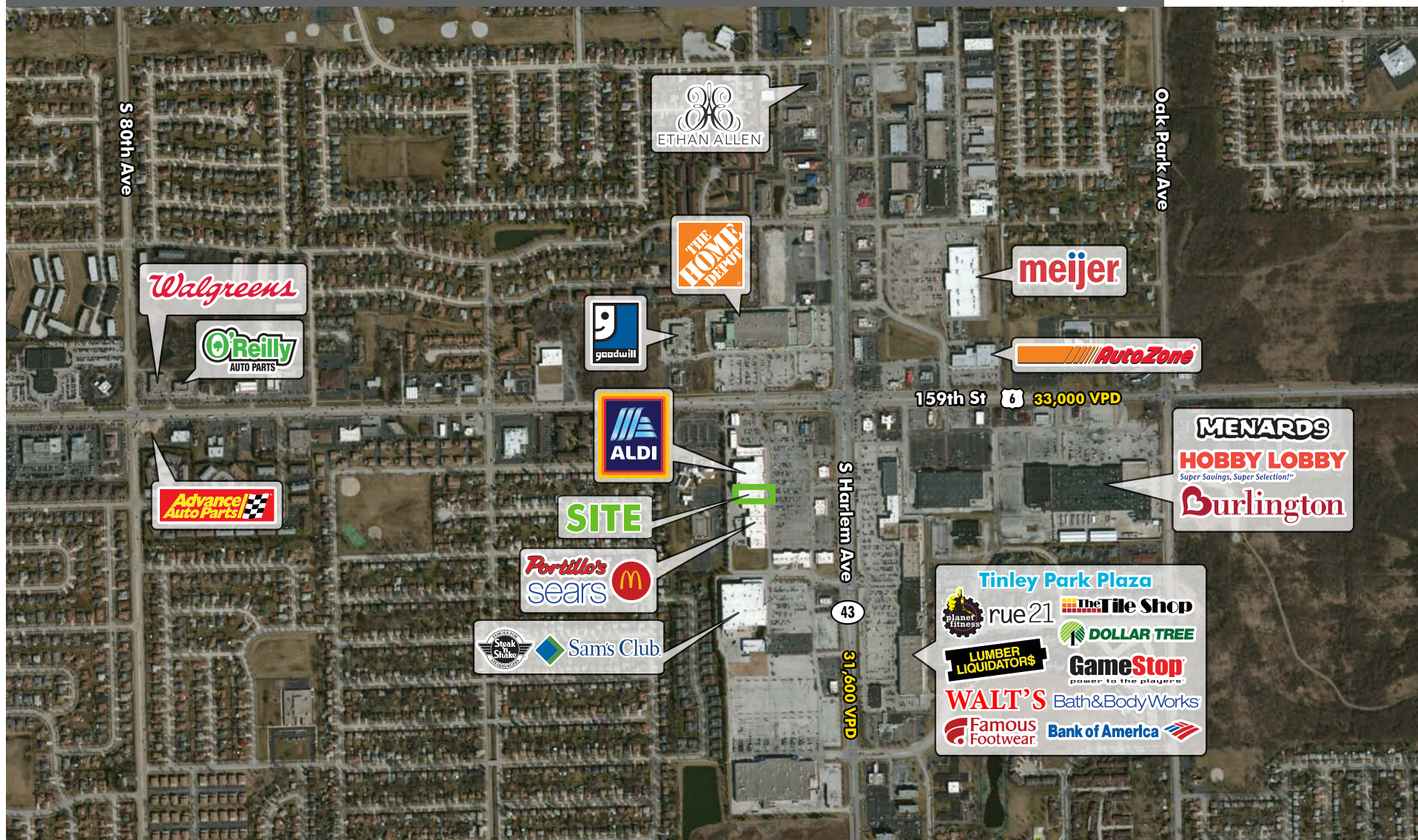

NORTH

[www.cbre.com](http://www.cbre.com)

CBRE

FOR SALE OR LEASE - ALDI EXCESS PROPERTY

±39,824 SF DIVISIBLE

16000 SOUTH HARLEM AVENUE, TINLEY PARK, ILLINOIS

RETAIL

## SITE PLAN

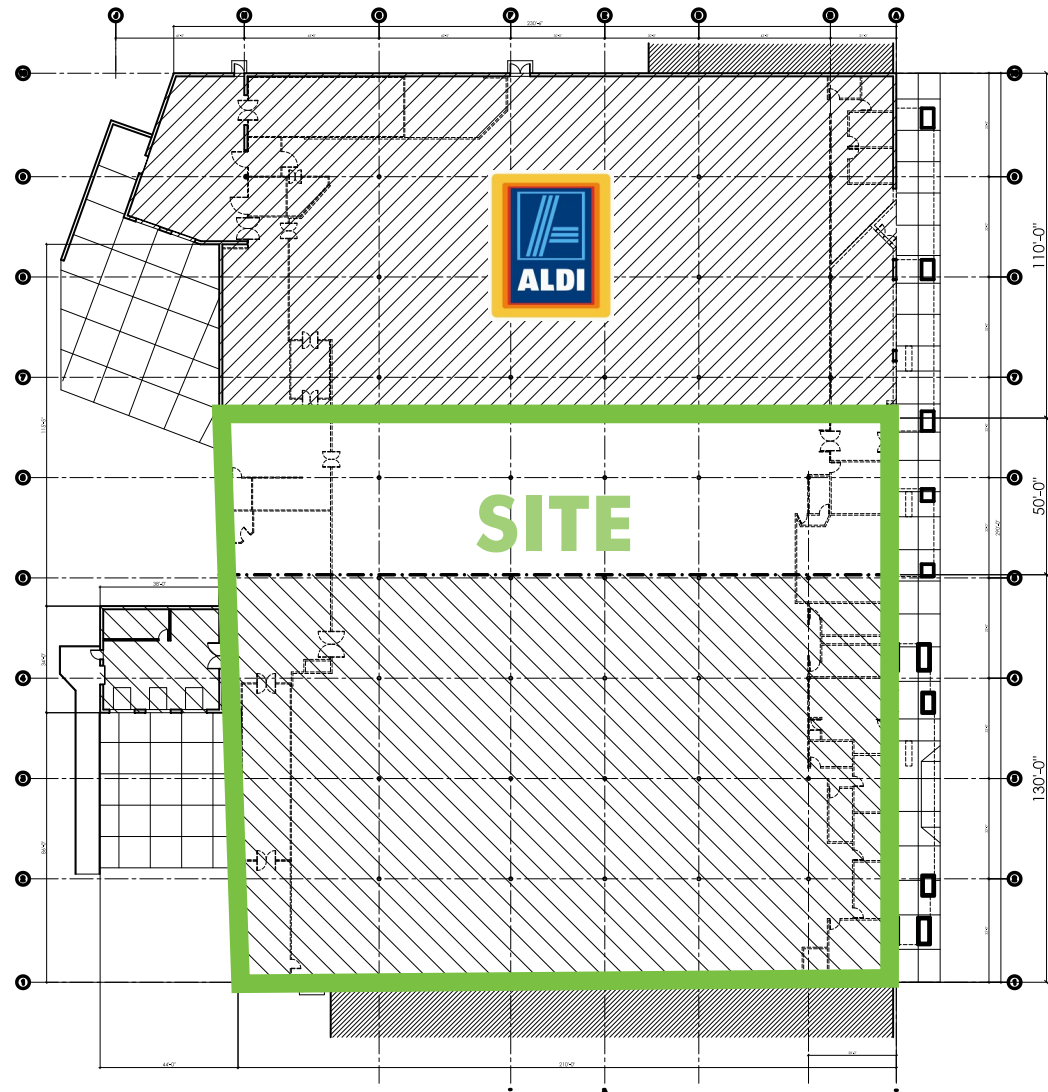

NORTH ▲

[www.cbre.com](http://www.cbre.com)

CBRE



## FOR SALE OR LEASE - ALDI EXCESS PROPERTY

# ±39,824 SF DIVISIBLE

16000 SOUTH HARLEM AVENUE, TINLEY PARK, ILLINOIS

RETAIL

## PROPERTY FEATURES

### ±39,824 SF DIVISIBLE

- Price: \$2,750,000
- Adjacent to new Aldi Store
- Surrounding tenants include: Portillo's, Sears, Sam's Club, Hobby Lobby, and Meijer
- Ample parking
- Excellent visibility from Harlem Ave. (31,600 VPD)
- PIN: 27-24-201-014-0000

## DEMOGRAPHICS

	1 MILE	3 MILES	5 MILES
POPULATION	12,795	92,227	200,614
AVERAGE HH INCOME	\$82,032	\$92,133	\$96,019
DAYTIME POPULATION	7,375	29,836	92,021

## MICRO AERIAL



NORTH ▲

## CONTACT US

### Peter Graham

First Vice President  
312 861 7851  
peter.graham@cbre.com

### Brent Wayburn

First Vice President  
312 935 1906  
brent.wayburn@cbre.com

© 2018 CBRE, Inc. All rights reserved. This information has been obtained from sources believed reliable, but has not been verified for accuracy or completeness. You should conduct a careful, independent investigation of the property and verify all information. Any reliance on this information is solely at your own risk. CBRE and the CBRE logo are service marks of CBRE, Inc. All other marks displayed on this document are the property of their respective owners. Photos herein are the property of their respective owners. Use of these images without the express written consent of the owner is prohibited.

[www.cbre.com](http://www.cbre.com)

**CBRE**